

EP75-EP110 EI-PTO Instruction manual

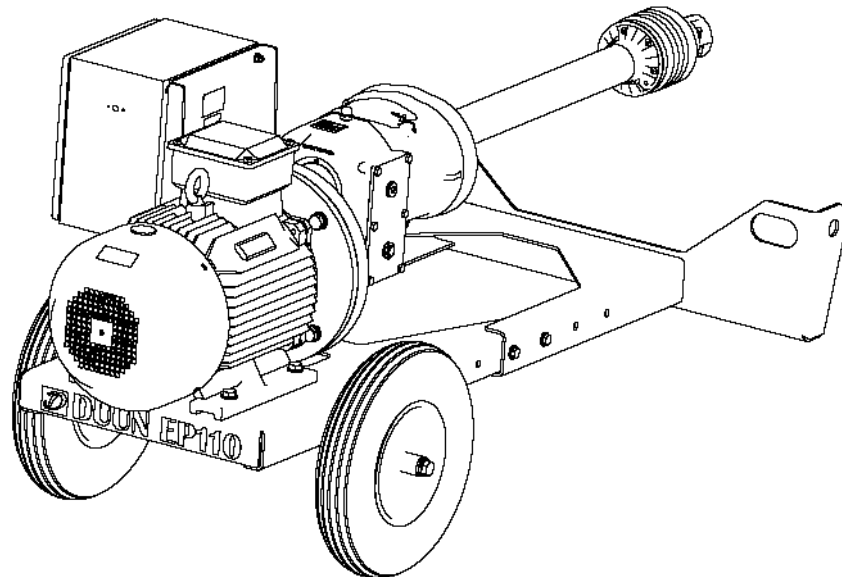
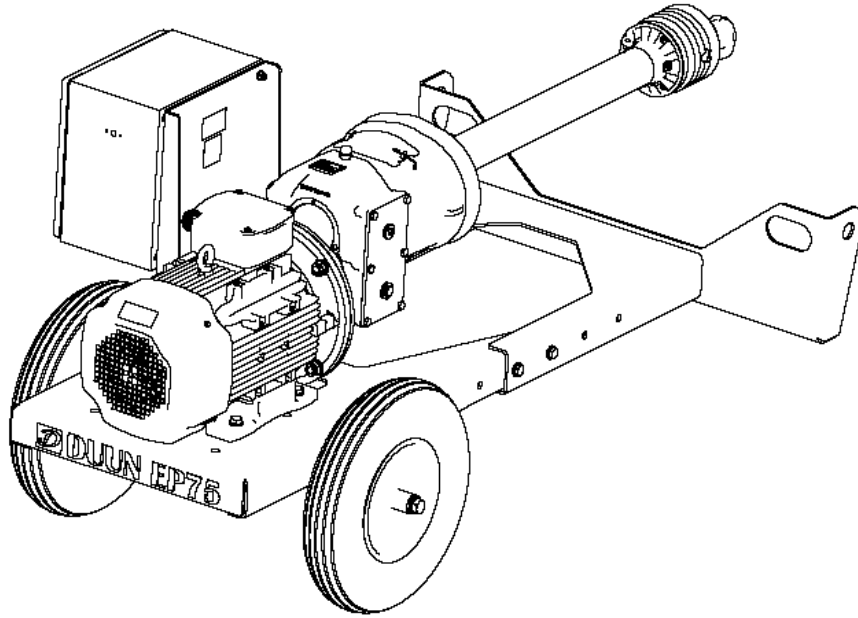

Congratulations on the purchase of Duun EP75-110 EI-PTO.

All Duun tractor operated machines have been engineered and tested in close cooperation with representative users to produce functionally safe and user-friendly machines.

Please read this instruction manual before using the machine.

Good luck!

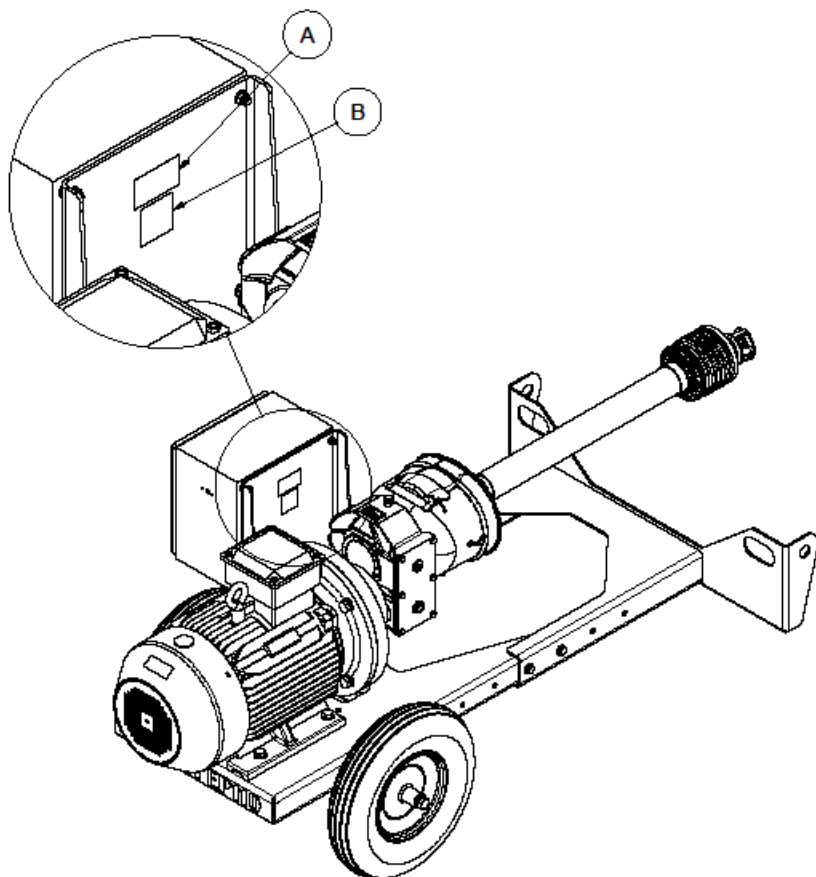

Machine identification

Serial number and manufacturer are indicated on badge [B]

Register serial number and delivery time as indicated.

Always specify serial number when requesting service for the machine.

The machine is CE-marked (B). This marking confirms that the machine has been manufactured in conformity with EU Directive Machinery.

Serial number

Time of delivery (month/year)

CONTENT

MACHINE IDENTIFICATION	2
SAFETY	4
WARRANTY TERMS	6
TECHNICAL DATA	7
PREPARATION FOR USE	8
ATTACHMENT TO THE FIREWOOD PROCESSOR	8
POWER CONNECTION	8
GEARBOX	9
DECLARATION OF CONFORMITY	10

SAFETY

All operators, mechanics and the owner must always work carefully with agricultural machinery. Read and observe safety instructions in this instruction manual.



Be particularly aware of warning signs with this symbol, it marks measures that must be carried out in order to avoid accidents. The symbol appears in the instruction manual and on warning signs on the machine.

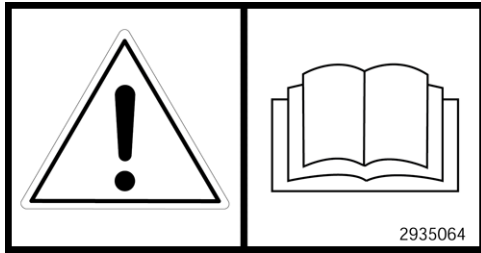

Instruction manual

All operators, mechanics and the owner must be well acquainted with the instruction in this instruction manual before the machine is taken into use.

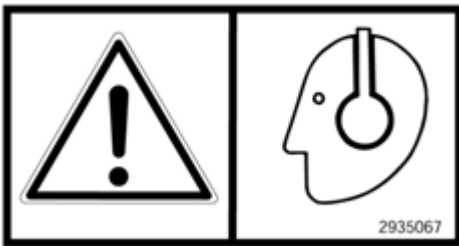

Safety equipment

Always wear hearing protection and safety glasses when using the firewood processor. Furthermore, safety shoes and sturdy work gloves should be worn when operating the machine and materials.



Clothing and rotating shaft

Do not work in clothing that can be pulled into moving parts of the machine (e.g. scarves, long coats).

The tractor is disengaged and the handbrake is applied before the shaft is connected to the tractor's PTO.

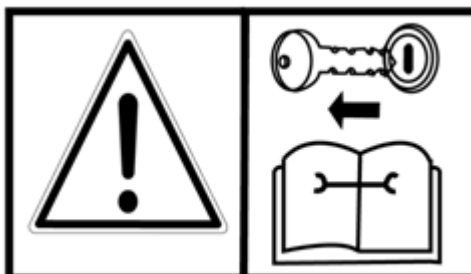

Safety in case of interruptions and maintenance

Remember always to stop the tractor's engine and remove the ignition key before you lubricate, adjust, clean, or carry out repairs. This is to secure that the tractor does not start before you have completed the operation.



High risk of crushing

Pay particular attention to the risk of crushing at points marked for this.

Usage options

The machines are only designed to drive Duun firewood processors which must have 400 rpm on the spigot.

EP75 is suitable for VM320 and VM370.

EP110 is suitable for VM320, VM370 and VM370x

ATTENTION! The electric drive is not a tractor and cannot be used to operate machines that need more power than the engine is rated for.

Before starting up after maintenance, check that all tools have been removed and replaced.

Before starting the machine, check that no one is near or touching the machine.

If warning signs are removed during repairs or service, new signs must be installed immediately!

Warranty terms

Duun EI-PTO EP75 and EP110 has 12 months guarantee against defects in materials and workmanship.

Parts that are not originally manufactured by Duun Industrier as, for example, wheels, hydraulic parts, etc. are subject to these suppliers' guarantees and terms.

Parts that are considered wearing parts, are not included in the warranty, these are specified in the bottom of this page.

In cases where a repair is considered to be covered by the guarantee, the representative must inform the supplier's representatives that the repair is intended executed based on the guarantee.

In this context, the following information must be recorded:

- Product name
- The product's serial no. (see the machine identification p.2)
- Date of sale
- The product owner's address, telephone no.
- Seller with address, tel. no.

In case of such a repair, the supplier is presented with a claim within 3 weeks after the repair date.

Replaced parts are to be kept until a decision has been made with reference to the claim and the replaced parts are to be forwarded to Duun Industrier as for assessment if so required.

As the employment of the product is beyond our control, we may only guarantee the quality and do not accept liability for the product's general performance.

Warranty liability requires that scheduled maintenance be performed.

Duun Industrier as reserves the right to modify the design and specifications and/or make alterations and improvements without notification.

What is not included in the guarantee:

- The guarantee does not cover economic loss as a consequence of interruptions.
- The guarantee does not cover consequential loss due to defects.
- The guarantee does not cover defects or damage caused by misuse and uses that are not in accordance with the instruction manual's specifications and guidelines.

Technical data

Features:	EP75	EP110
Weight		
Length	1439 mm	1577,5 mm
Height	769,5 mm	769,5 mm
Width	945 mm	945 mm
Power requirement 230V	7,5 kw 32A fuse	11 kw 63A fuse
Power requirement 400V	7,5 kw 16A fuse	11 kw 32A fuse

EP75

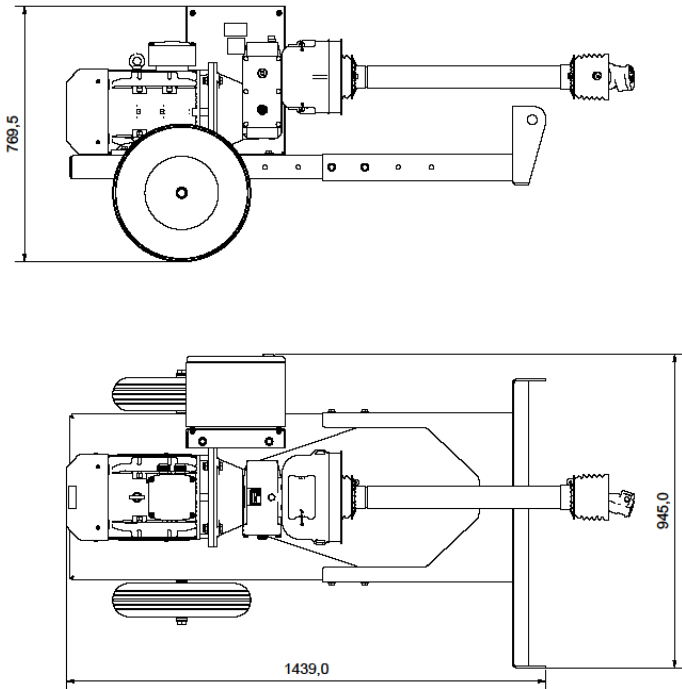

EP110

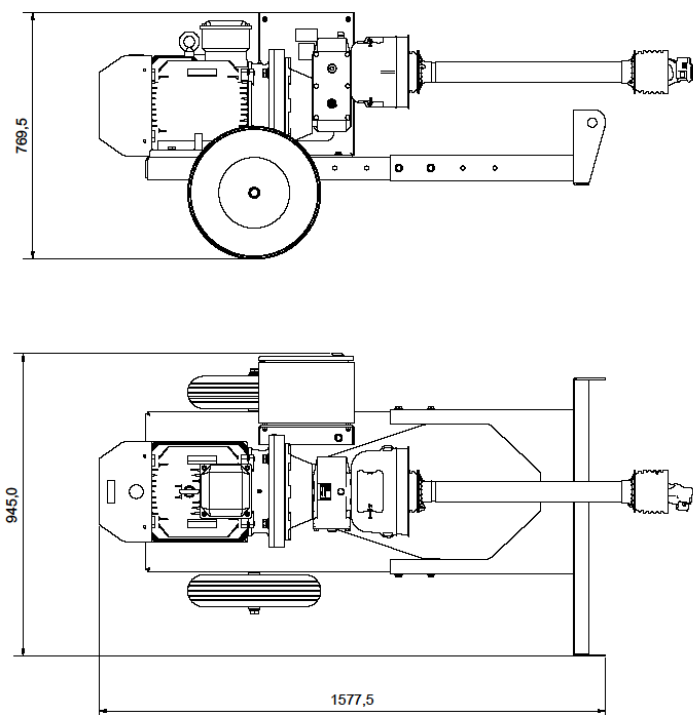

Preparations for use

Attachment to the firewood processor

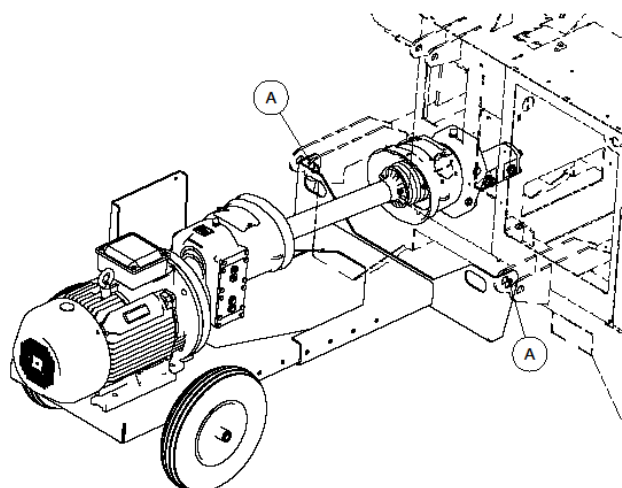

The EP75 and EP110 have wheels and can be easily moved by driving them like a wheelbarrow. They are attached to the firewood processor using drawbar bolts illustrated with A.

Power connection

The electrical operation requires three phases and a fuse according to the counter size and volt.

EP75

7.5 kw motor that gives 400 rpm on the firewood processor tap.

Fits VM320 and VM370

16A fuse at 400 volts

32A fuse at 230 volts

EP110

11kw motor that gives 400 rpm on the firewood processor tap.

Fits VM320, VM370 and 370x

32A fuse at 400 volts

63A fuse at 230 volts

Important at start-up to see if the motor turns in the correct direction!

The motor is marked with a sticker (A) which shows the direction of rotation of the motor's fan.

If the fan rotates in the opposite direction than indicated on the sticker, contact an electrician and turn on the power to correct the direction.

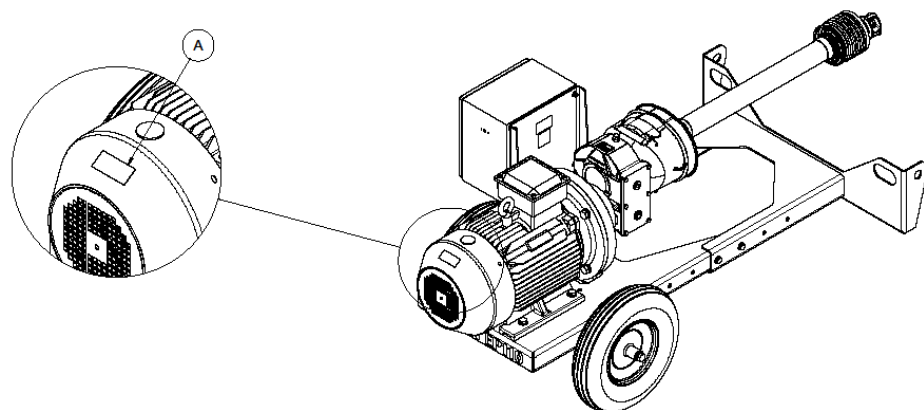

Maintenance

The machine needs regular cleaning to keep the cooling of the electric motor and gearbox. Blow clean with compressed air.

Gearbox

Recommended oil: Gearbox oil Mereta 220 synthetic oil (Statoil) or Esso Syntetic EP150.
Other oil must meet standard SAE90EP or GL5
Mereta 220 - 1 ltr. has item no. 531 0 110

Check the oil level after 50 operating hours or after each season by loosening the level screw marked B, as illustrated in the sketch (oil should then leak out at a sufficient level).

If the oil level requires refilling, use the same type of oil.

The first oil change is recommended after 50 hours of use, and then every second season or after 500 operating hours - i.e. if 500 operating hours occur before the end of the 2nd season, an oil change with Mereta 220 is carried out as indicated.

It is an advantage to change the oil when the gearbox is worn.

A- Air plug/filler plug.

B- Oil level plug

C- Drain plug

It is very important to fill the gearbox with the correct amount of oil.

Too much oil will lead to a higher operating temperature and risk of breakdown.

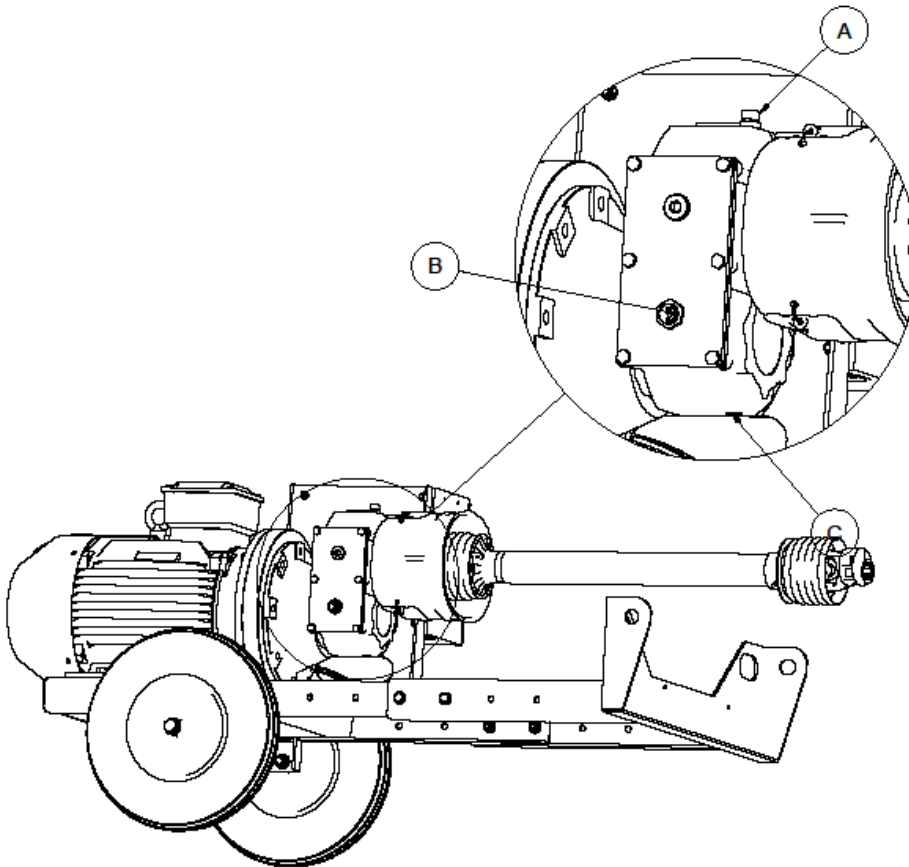

Declaration of conformity

Responsible person

Name: Karl Martin Eggen
Position: CEO
Company name: Duun Industrier as
Address: N-7630 Åsen
Norway
Telephone: +47 74 01 59 00

Person responsible for the technical documentation: Rolf Even Duun

Declares that the following machine: EP75 EL Tractor
Manufacturer: Duun Industrier as
Type: Duun EL Tractor EP75
is in accordance with:

Directive 2006/42/EC Machinery

Signed by:



Karl Martin Eggen

Åsen, 15.09.2020

Declaration of conformity

Responsible person

Name: Karl Martin Eggen
Position: CEO
Company name: Duun Industrier as
Address: N-7630 Åsen
Norway
Telephone: +47 74 01 59 00

Person responsible for the technical documentation: Rolf Even Duun

Declares that the following machine: EP110 EL Tractor
Manufacturer: Duun Industrier as
Type: Duun EL Tractor EP110
is in accordance with:

Directive 2006/42/EC Machinery

Signed by:



Karl Martin Eggen

Åsen, 15.09.2020